

1610nm DFB 2mw Coaxial Pigtail Laser Diode with SMF
1610nm Fiber Coupled LD with Single Mode Fiber (SM Fiber)
WSLP-1610-002m-9-DFB

PARAMETER	SYMBOL	VALUE	UNIT
LD Reverse Voltage	V_r	2.0	V
PD Operating Current	$I_{f(PD)}$	2.0	mA
PD Reverse Voltage	$V_{r(PD)}$	15	V
Operating Temperature	T_{op}	-10 ~ +85	°C
Storage Temperature	T_{stg}	-40 ~ +85	°C
Lead soldering temperature (10 sec.)	T_{is}	260	°C
Features: <ul style="list-style-type: none"> ● 1610nm ● DFB Laser Diode ● Built-in Photodiodes ● 9um SM Fiber ● Isolator Optional ● Coaxial or Receptacle Package Optional 			
Applications: <ul style="list-style-type: none"> ● Test Equipments ● Optical Transmitter of Analog Signal ● Optical Transmitter of Data Signal 			
Specifications	WSLP-1610-002m-9-DFB		
	Min	Type	Max
Center Wavelength@25°C	+/-2nm	1610nm	+/-3nm
Laser Type	DFB		
Output Power	----	2mW	----
Fiber Core	9um SM Fiber		
Threshold Current (Typ.) I _{th}	5mA	11mA	15mA
Operating Current	----	30mA	35mA
Forward Voltage	----	1.1V	1.6V
Monitor Current	0.1mA	----	----
PD Capacitance	----	10pF	15pF
PD Dark Current	----	----	0.1uA
Side Mode Suppression Ration	30dB	35dB	----
Package Style	Coaxial (Receptacle Optional)		
Data Rate	1.25Gb/s		
Isolator	Optional		
Connector Pin	A-type (B-type Optional)		
Fiber Connector	FC		

Coaxial Package View

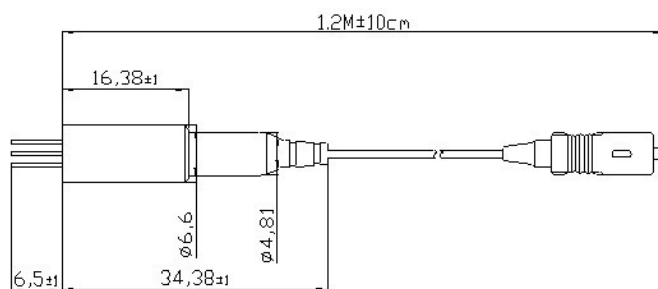

Bottom View

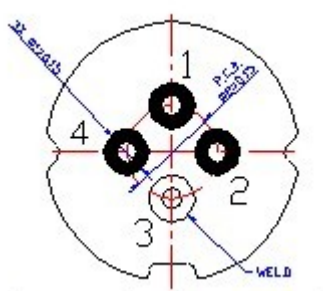

TYPE A
PIN ASSIGNMENT:

1	PD Cathode
2	PD Anode
3	LD Anode, GND
4	LD Cathode

Electrically shorten LD module and store in non-extreme conditions.
Suggest using the constant current power supply.

