

## MGL-DS series

### LD PUMPED ALL-SOLID-STATE LOW NOISE GREEN LASER

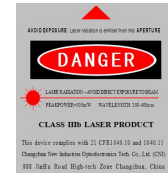

All solid state single longitudinal mode green laser is made features of ultra compact, small size, photoelectric integrated, built-in electric shutter, long lifetime, low cost and easy operating, which is used in DNA sequencing, flow cytometry, cell sorting, optical instrument, spectrum analysis, interference, measurement, holography, physics experiment, etc.



#### SPECIFICATIONS

Part number	MGL-DS-530	MGL-DS-532
Wavelength (nm)	530±1	532±1
Operating mode	CW	
Output power before fiber (mW)	1-50	1-150
Power stability (rms, over 4 hours)	<3%, <2%, <1%	<3%, <2%, <1%
Transverse mode	TEM <sub>00</sub>	
M <sup>2</sup> factor	<1.2, <1.1	
Beam diameter at the aperture( 1/e <sup>2</sup> ,mm)	<1.0	
Beam divergence, full angle (mrad)	<1.5	
Polarization ratio	>100:1, Horizontal (Vertical Optional)	
Pointing stability after warm-up (mrad)	<0.05	
Pointing stability Over Temp. (μrad/°C)	<8	
Warm-up time (minutes)	<5	
Beam height from base plate (mm)	19	
Power Consumption(W)	<6	
Fiber(optional)	Multi mode/Single Mode	
Shock Tolerance(6ms)	7g laterally, 15g vertically	
Power Supply	5V DC (Photoelectric integrated)	
Operating temperature (°C)	10-35	
Storage temperature (°C)	5-50	
Modulation	Modulation isn't available.	
Expected lifetime (hours)	10000	
Warranty	1 year	

**Note:** The laser head needs to be used on a heat sink with good heat dissipation.

LASER HEAD (Without Fiber)

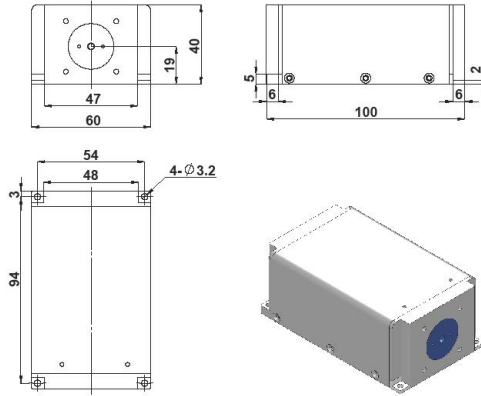

100 (L) × 60 (W) × 40(H) mm<sup>3</sup>, 0.41kg

LASER HEAD (With Multi mode Fiber)

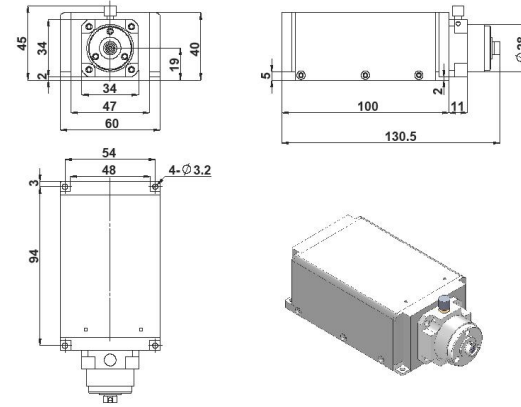

130.5(L) × 60(W) × 45(H) mm<sup>3</sup>, 0.5kg

LASER HEAD (With Single Mode Fiber)

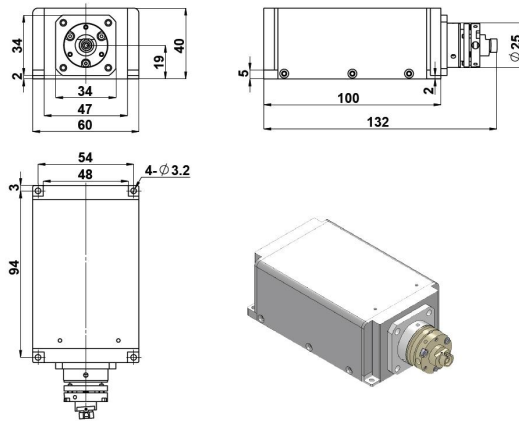

139(L) × 60(W) × 46(H) mm<sup>3</sup>, 0.54kg

POWER ADAPTER

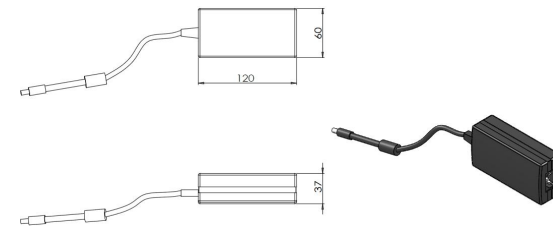

130.5(L) × 60(W) × 45(H) mm<sup>3</sup>, 0.5kg